

**COLEMAN COMMUNITY
REDEVELOPMENT PLAN
City Of Coleman
Sumter County, Florida**

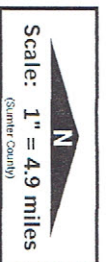

Disclaimer: This map and/or digital data is for planning purposes only and should not be used to determine the precise location of any feature. The Withlacoochee Regional Planning Council provides no warranty for the accuracy or suitability of the data.

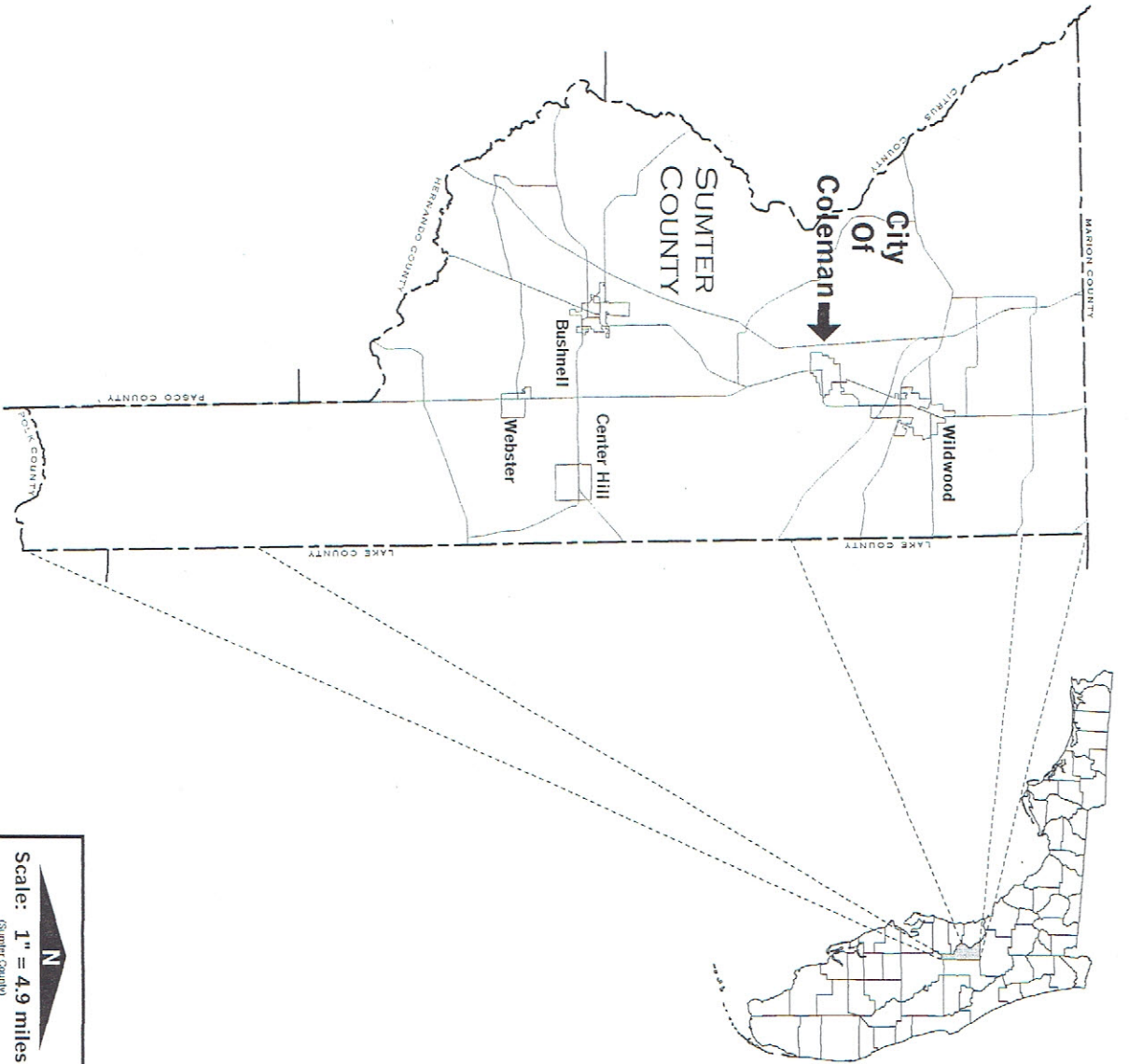
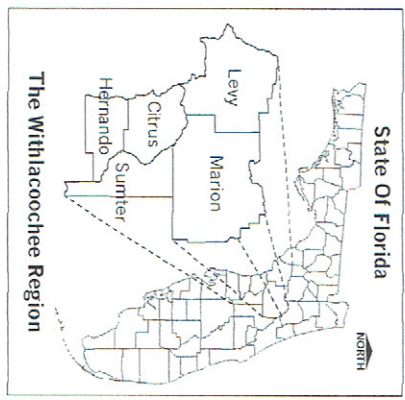

FIGURE 1.0

**General Location
Map**

Credits: Prepared by the Withlacoochee Regional Planning Council
 FileNm: D:\local\p\rg\Coleman_CRA\Chm\CFA_LockMap.wor (06-02-03)

**COLEMAN COMMUNITY
REDEVELOPMENT PLAN**
City Of Coleman
Sumter County, Florida

Key:
The Coleman Community Redevelopment Area boundary is the same as the Coleman City Limit boundary.

- Coleman City Limits
- Parcels (by ownership, not lot specific)
- Railroads

Source(s):

- Withlacoochee Regional Planning Council staff
- Parcel Data, Sumter County Public Works, August 22, 2002
- The Sumter County Public Works office does not take responsibility for errors and/or omissions regarding this mapping information)

FIGURE 2.0

**City Limit Boundary
Showing
Community Redevelopment Area**

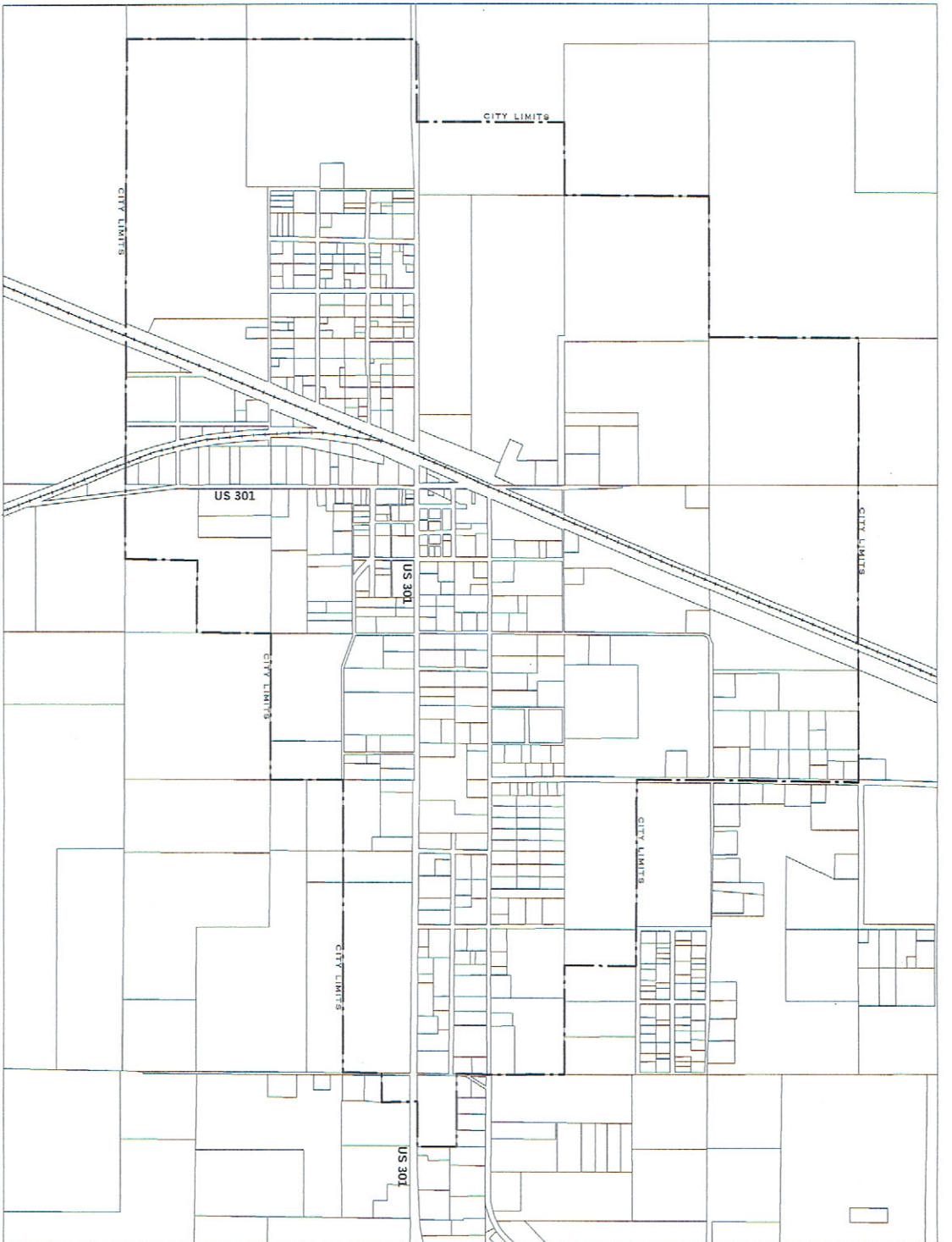

Credits: Prepared by the Withlacoochee Regional Planning Council
Filename: D:\LocalP\fig\Coleman_CRA\Crncrpa_Fig2.0.wor (06-26-03)

Disclaimer: This map and/or digital data is for planning purposes only and should not be used to determine the precise location of any street. The Withlacoochee Regional Planning Council provides no warranty for the accuracy or suitability of the data.

**COLEMAN COMMUNITY
REDEVELOPMENT PLAN**
City Of Coleman
Sumter County, Florida

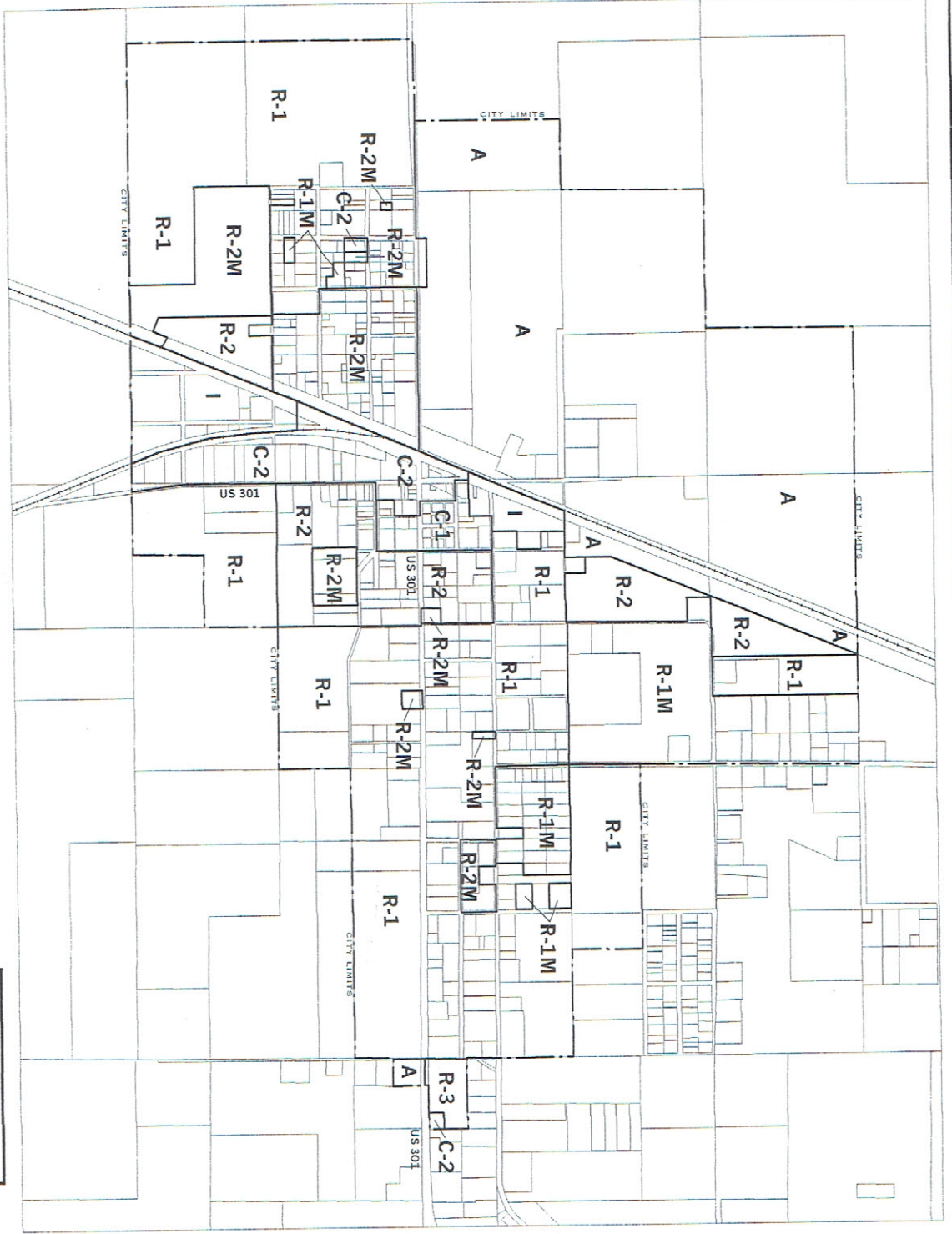

Key:
The Coleman Community Redevelopment Area boundary is the same as the Coleman City Limit boundary.

- Coleman City Limits
- Parcels (by ownership, not lot specific)
- Railroads
- Existing Zoning Districts
- R-1 Zoning District Designation

City Of Coleman Zoning Districts Categories:

- A Agricultural - Conservation
- R-1 Single-Family Residential
- R-1M Low Density (Mobile Home)
- R-2 Medium Density Residential
- R-2M Medium Density (Mobile Home)
- R-3 High Density Multifamily Residential
- R-3M High Density Mobile Home Parks and Subdivisions
- C-1 Office/Professional Commercial
- C-2 Highway Commercial
- I Light Industry

Source(s):

- Withlacoochee Regional Planning Council staff
- Parcel Data, Sumter County Public Works, August 22, 2002
- The Sumter County Public Works office does not take responsibility for errors and/or omissions regarding this mapping information)
- Coleman Existing Zoning District information created as heads-up coverage referencing the copy map provided by the City of Coleman, July 7, 2005

FIGURE II.1

Existing Zoning

Credits: Prepared by the Withlacoochee Regional Planning Council
File: R-1, D:\Local\Ring_Coleman_CORA\ComPlan_E-2\Ring_wor (rev. 07.10.03)

Disclaimer: This map and/or digital data is for planning purposes only and should not be used to determine the precise location of any feature. The Withlacoochee Regional Planning Council provides no warranty for the accuracy or completeness of the data.

**COLEMAN COMMUNITY
REDEVELOPMENT PLAN**
City Of Coleman
Sumter County, Florida

Key:

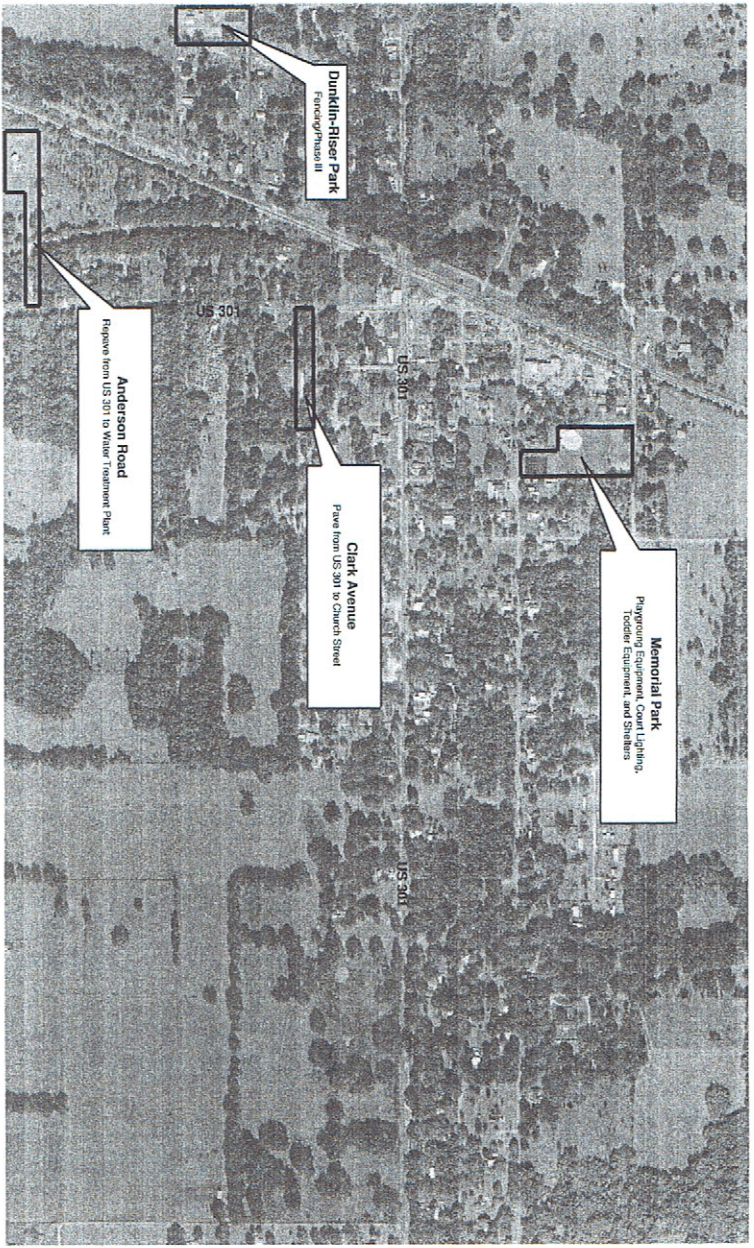

Source(s):

- Withlacoochee Regional Planning Council staff
- Parcel Data, Sumter County Public Works, August 22, 2002 (The Sumter County Public Works office does not take responsibility for errors and/or omissions regarding this mapping information)
- Aerial photographic background provided by F.D.O.T. via Inwood Consulting Eng. (06-03)

FIGURE III.1

Planned Public Improvements

Disclaimer: This map and/or digital data is for planning purposes only and should not be used to determine the precise location of any feature. The Withlacoochee Regional Planning Council provides no warranty for the accuracy or availability of the data.

**COLEMAN COMMUNITY
REDEVELOPMENT PLAN**
City Of Coleman
Sumter County, Florida

Key:

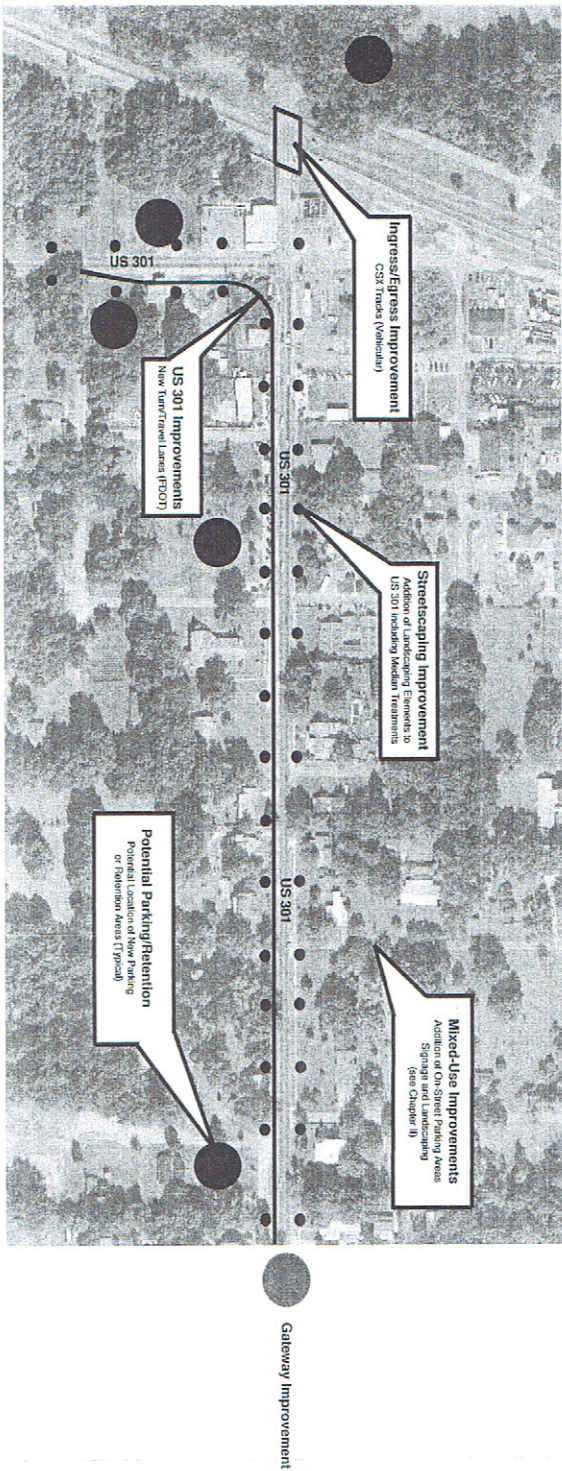

Source(s):

- Wilkesochee Regional Planning Council staff
- Parcel Data, Sumter County Public Works, August 22, 2002 (The Sumter County Public Works office does not take responsibility for errors and/or omissions regarding this mapping information)
- Aerial photographic background provided by F.D.O.T. via Inwood Consulting Eng. (06-03)

FIGURE III.2

Proposed Public Improvements

Disclaimer: This map and/or digital data is for planning purposes only and should not be used for any other purpose. The Planning Council provides no warranty for the accuracy or availability of the data.

**COLEMAN COMMUNITY
REDEVELOPMENT PLAN**
City Of Coleman
Sumter County, Florida

Key:

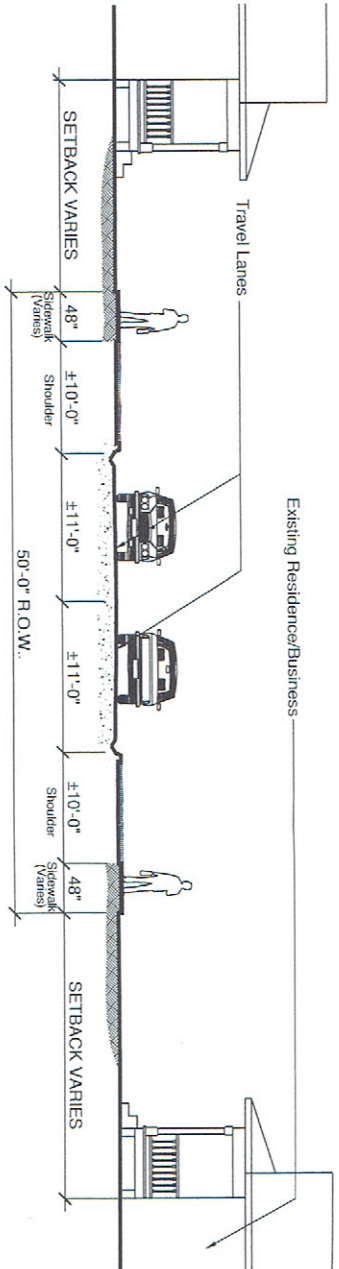

Existing Cross Section

Scale: 1" = 10'-0"

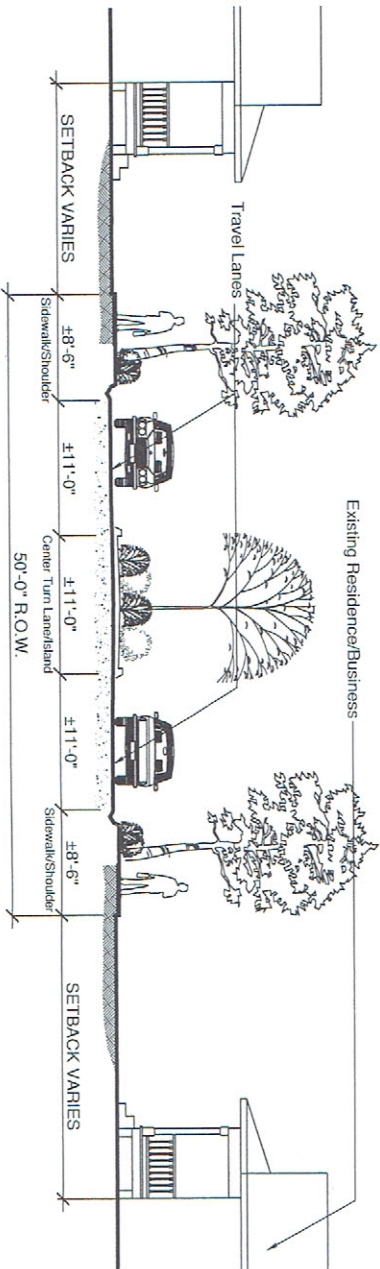

Proposed Cross Section

Scale: 1" = 10'-0"

Disclaimer: This map and/or digital data is for planning purposes only and should not be used to determine the precise location of any feature. The Whitehouse Report Planning Council provides no warranty for the accuracy or reliability of the data.

Source(s):

- Whitehouse Regional Planning Council staff
- Parcel Data, Sumter County Public Works, August 22, 2002
- (The Sumter County Public Works office does not take responsibility for errors and/or omissions regarding this mapping information)

FIGURE V.1

**Existing and Proposed
U.S. Highway 301 Cross Sections**

**COLEMAN COMMUNITY
REDEVELOPMENT PLAN**
City Of Coleman
Sumter County, Florida

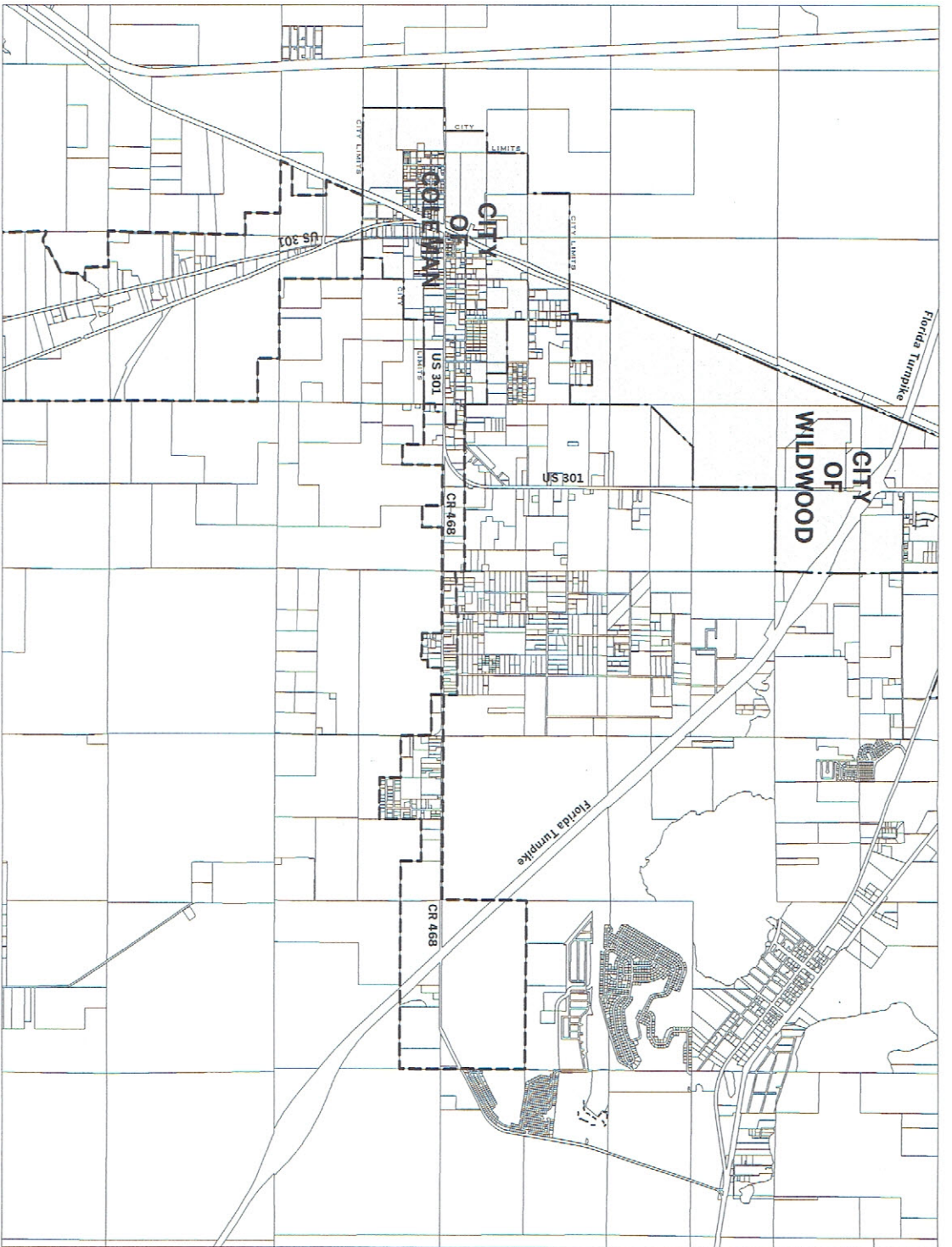

Scale: 1" = 3358 feet

Disclaimer: This map and/or digital data is for planning purposes only and should not be used to determine the precise location of any feature. The Withlacoochee Regional Planning Council provides no warranty of the accuracy or suitability of the data.

Key:
The Coleman Community Redevelopment Area boundary is the same as the Coleman City Limit boundary.

- City Limit Boundaries
- Parcels (by ownership, not lot specific)
- Railroads
- Proposed Areas of Annexation*

*Note: Proposed areas of annexation are not meant to be parcel specific. Rather, the boundary is meant to indicate areas for future consideration to include the proposed Turnpike-CR 468 Interchange to the east and areas toward Sumterville to the south.

Source(s):

- Withlacoochee Regional Planning Council staff
- Parcel Data, Sumter County Public Works, August 22, 2002
- (The Sumter County Public Works office does not take responsibility for errors and/or omissions regarding this mapping information)

FIGURE VI.1

**Proposed Areas
of Annexation**